

# Remote Switch Laser Sight for Picatinny Rail and M-Rail

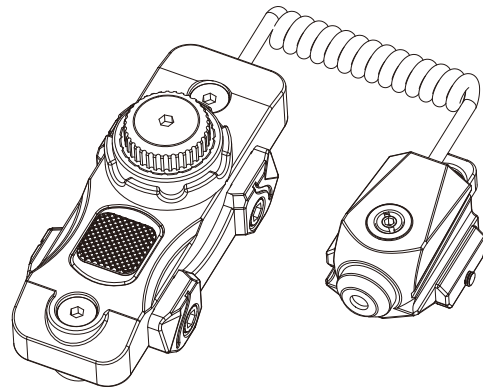

USER MANUAL

## 1. SPECIFICATIONS

Laser Type	Red	Green	Blue	Purple	IR
Wavelength	650NM	520NM	450NM	405NM	850NM
Running Time	8Hrs	2.5Hrs	2.5Hrs	2.5Hrs	8Hrs
Battery	CR-1/3N				
Laser visible Distance	Maximum 200m during daytime, maximum 2000m at night				
Dimensions	remote switch: 3.14in*1.29in*1.16in Laser Sight: 1.77in*1.06in*0.9in				
Waterproof level	IPX6				
Design Advantages	Compact, lightweight and portable design, does not block the installation of other gun accessories				

## 2. IN THE BOX

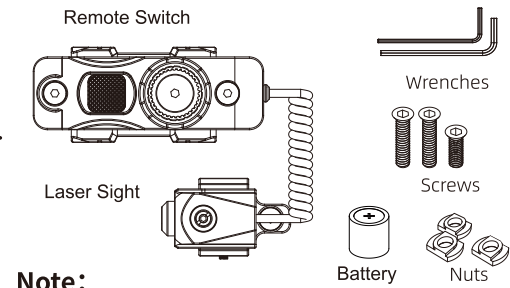

### Note:

1 M-LOK screw already installed on the sight, 2 on the remote switch

## 3. PRODUCT OVERVIEW

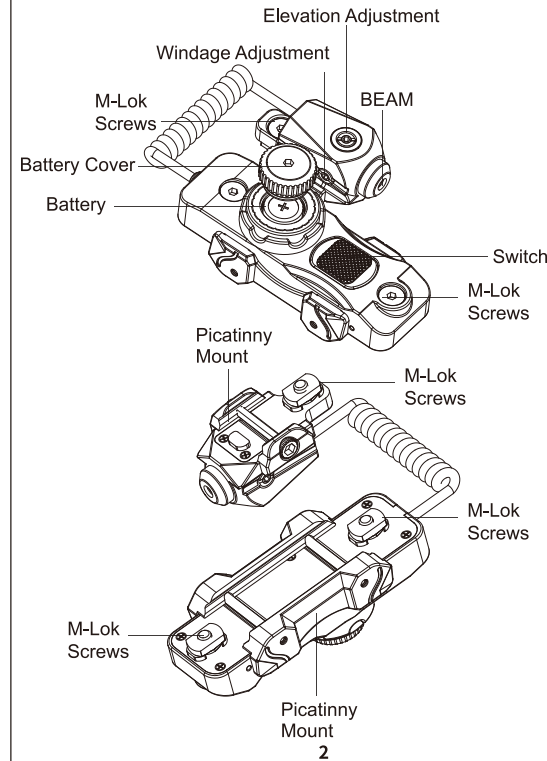

## 4. BATTERY INSTALLATION

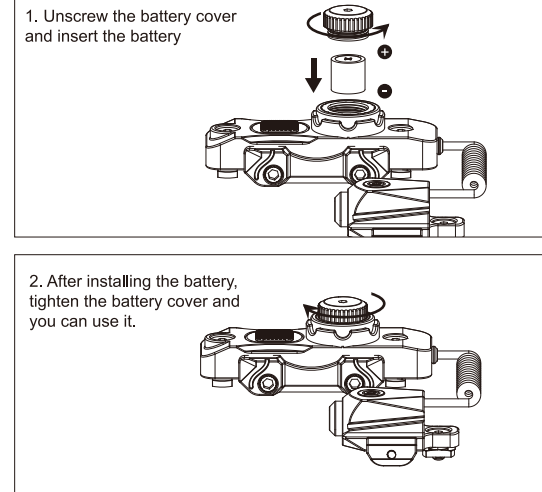

- Please install the battery before using the product for the first time.
- Unscrew the battery cover, put the battery in, tighten the battery cover, and it is ready for use. It is convenient for outdoor use. When the power runs out, quickly replace the spare battery and it can be used.
- If not in use for a long time, it is recommended to remove the battery and keep the product out of reach of children.

## 5. LASER SIGHT INSTALL

### For Picatinny Rail:

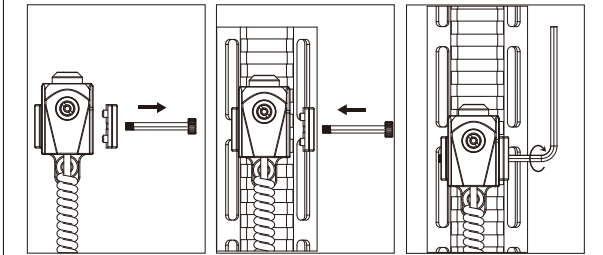

1. Loosen the screws with a wrench
2. Install it on the Picatinny rail.
3. After installing it in place, tighten the screws with a wrench.

### For M-Lok rail:

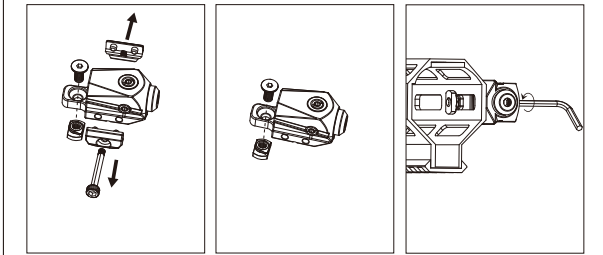

1. Loosen screws to remove the picatinny mount from the remote switch.
2. Install the M-Lok screw.
3. Align the M-Lok rail holes and tighten it with wrench.

## 6. REMOTE SWITCH INSTALL

### For Picatinny Rail:

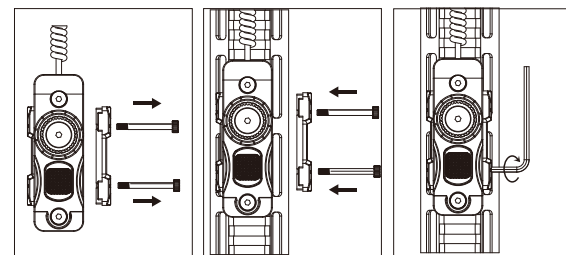

1. Loosen the screws with a wrench
2. Install it on the Picatinny rail.
3. After installing it in place, tighten the screws with a wrench.

### For M-Lok rail:

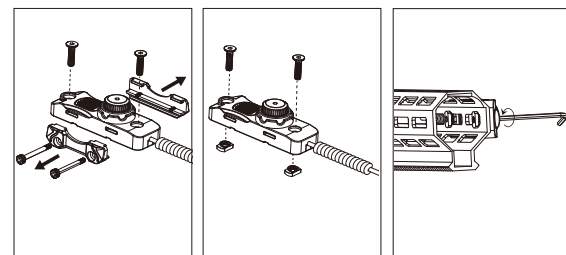

1. Loosen screws to remove the picatinny mount from the remote switch.
2. Install the M-Lok screw.
3. Align the M-Lok rail holes and tighten it with wrench.

## 7. PICATINNY INSTALLATION RAIL DIAGRAM:

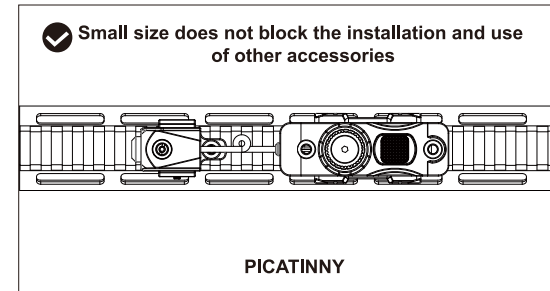

### Advantage Design:

1. Small size, compact structure, easy to carry.
2. After installation is completed, it will not block the installation of other accessories.
3. compatible with both M19 13 picatinny and M-LOK rails.
4. The battery is installed and has a long battery life. When the battery runs out outdoors, the battery can be quickly replaced.
5. Remote switch setting for quick aiming

## 8. M-LOK INSTALLATION RAIL DIAGRAM:

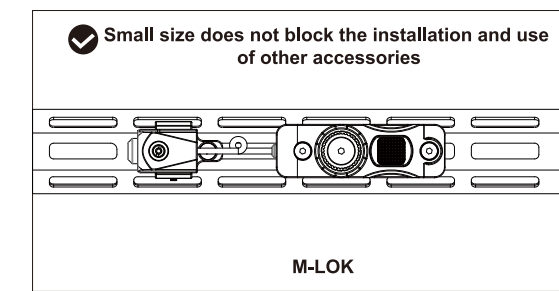

### Advantage Design:

1. Small size, compact structure, easy to carry.
2. After installation is completed, it will not block the installation of other accessories.
3. compatible with both M19 13 picatinny and M-LOK rails.
4. The battery is installed and has a long battery life. When the battery runs out outdoors, the battery can be quickly replaced.
5. Remote switch setting for quick aiming

## 9. REMOTE SWITCH OPERATION

With Remote Switch

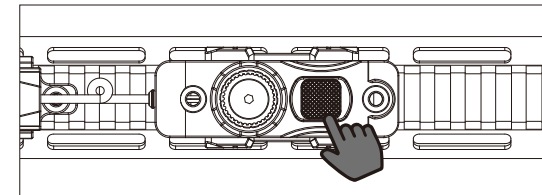

1. The laser sight has a large and easy access ON/OFF switch that is friendly for both left-handed and right-handed people.
2. There are two modes that can be operated by the ON/OFF switch:
  - Constant on mode: Press the button once.
  - Strobe mode: Press the button twice quickly to activate strobe mode, and press twice again to revert to constant on mode.

## 10. LASER CALIBRATION

Use the included Allen wrench to rotate the two screw holes on the side/bottom respectively to calibrate the vertical or horizontal angle of the laser.

### Attention:

- Please adjust the vertical and horizontal screws holes slowly and interactively, Adjusting only one screw hole may lock or damage the threads.
- Max turn the screw 2 circles in one direction.

**Elevation Adjustment:**  
Use a wrench to turn the side screw holes

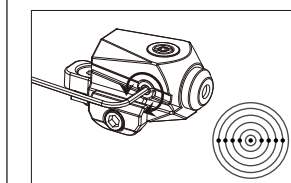

**Windage Adjustment:**  
Use a wrench to turn the top screw hole

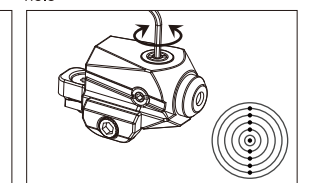

## 11. DANGER

- **DO NOT** throw the light directly into human eyes. It may cause temporary blindness, or permanent damage to the eyes.
- **DO NOT** soak the product in water for a long time

## 12. WARNING

Keep this product out of the reach of children.

If you are not going to use the Laser Sight for a long time, remove the battery from the Laser Sight.

## 13. NOTICE

The light emits a powerful beam and may become uncomfortably warm with extended use. This is normal and not indicative of a defect.

